

Customer name:

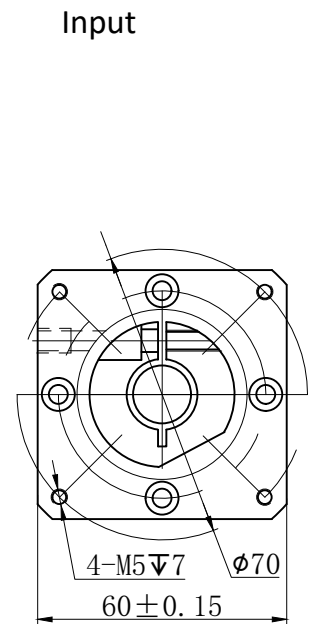
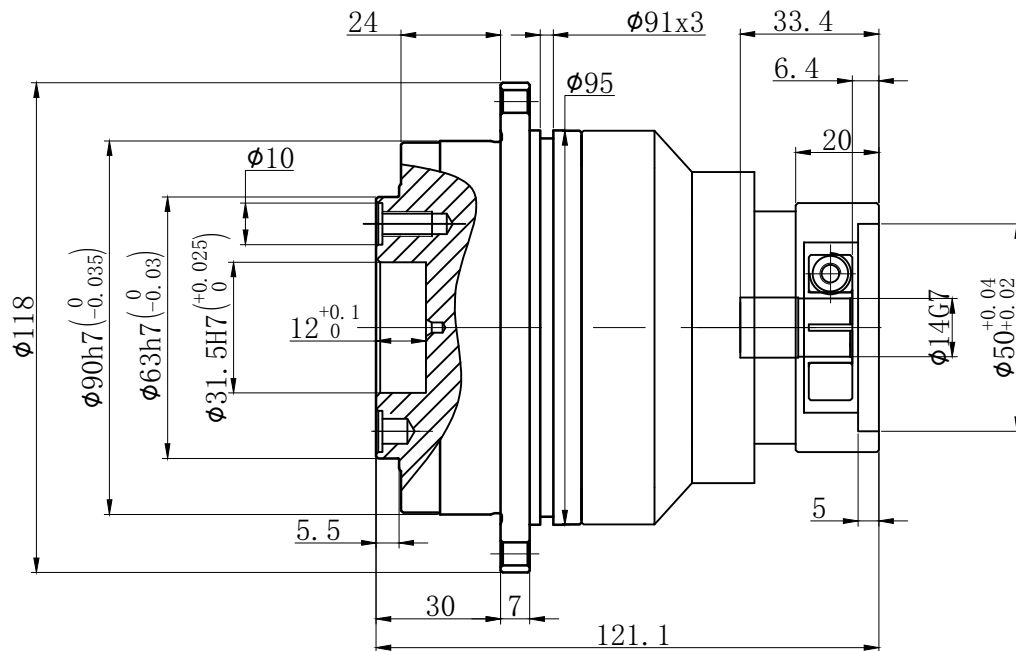
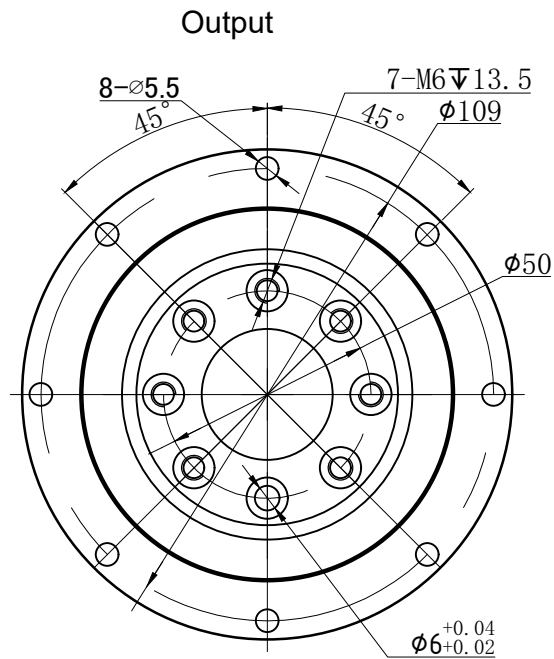

Transmission ratio	(<u>A</u>):1	Mass moments of inertia	(<u>B</u>)Kg.cm ²											
Rated output torque	(<u>C</u>)Nm	Max.output torque	(<u>D</u>)Nm	40	0.13	130	234	Sign/Date						
Rated input speed	4000rpm	Max input speed	8000rpm	35	0.13	140	252			100	0.13	100	180	
Max Benging Moment	235Nm	Max.axial force	2850N	25	0.13	160	280			70	0.13	140	252	
Efficiency	≥ 94%	Operating temperature	-20~+90°	20	0.13	130	234				50	0.13	160	280
Mounting position	Any	Lubrication method	Synthetic grease	Ratio	A	B	C	D	Ratio	A	B	C	D	
Weight ±3%	3.7Kg	Service life	20000h	Note						Precision planetary reducer		GD090		
Standard backlash	≤ 7 arcmin	Protection class	IP65									GD090-L2		
Motor power		Noise level	60dB									Shaft Type	Precision	
Motor dimensions														

Above specifications are for standard reducer and may be subject to change without notice.