

Customer name:

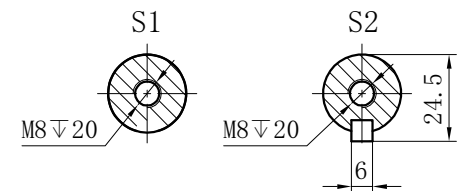
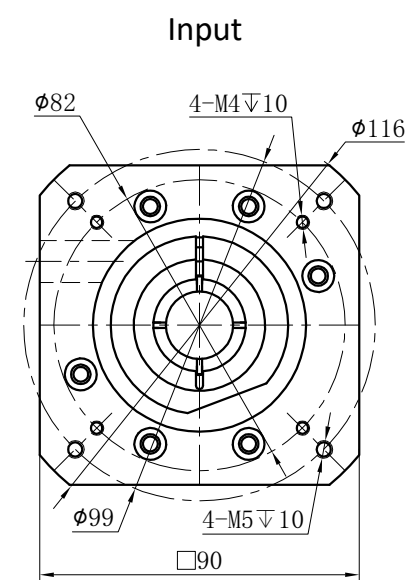
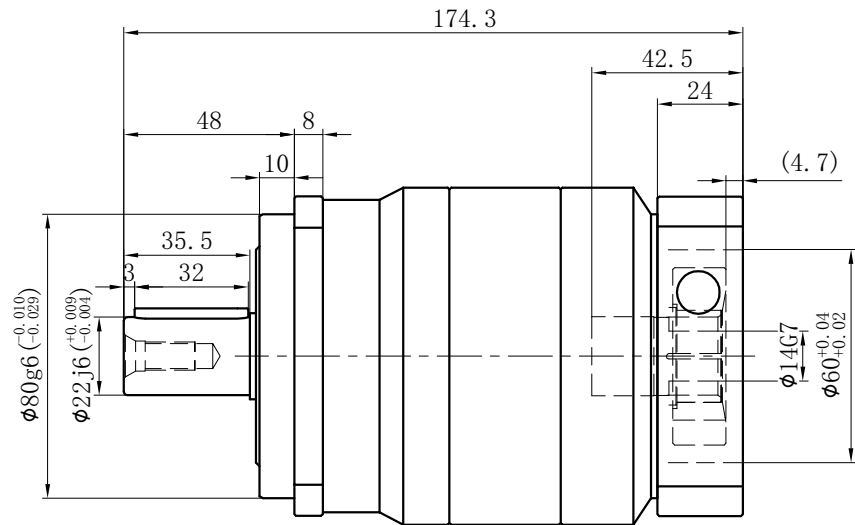
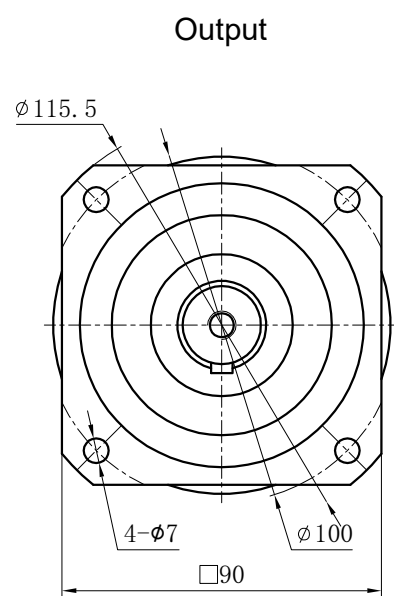

Transmission ratio	(A):1	Mass moments of inertia	(B)Kg.cm ²
Rated output torque	(C)Nm	Max.output torque	(D)Nm
Rated input speed	3000rpm	Max input speed	5000rpm
Max.radial force	3250N	Max.axial force	1625N
Efficiency	≥ 94%	Operating temperature	-20°~+90°
Mounting position	Any	Lubrication method	Synthetic grease
Weight ±3%	5.1Kg	Service life	20000h
Standard backlash	≤ 7 arcmin	Protection class	IP65
Motor power		Noise level	63dB
Motor dimensions			

	40	0.47	120	215	Sign/Date					
	35	0.47	135	240			100	0.44	100	180
	30	0.47	140	250			80	0.44	120	215
	25	0.47	150	270			70	0.44	135	240
	20	0.47	110	195			60	0.44	140	250
	15	0.47	100	180			50	0.44	150	270
Ratio	A	B	C	D		Ratio	A	B	C	D

Note					Precision planetary reducer	GCB090A		
Bushing φ19-φ14	Mark	No.	Sign	Date		GCB090A-L2		
		DRAW					Shaft Type	Precision
		CHEC						
	APPR							
	RULE							

Above specifications are for standard reducer and may be subject to change without notice.