

Customer name:

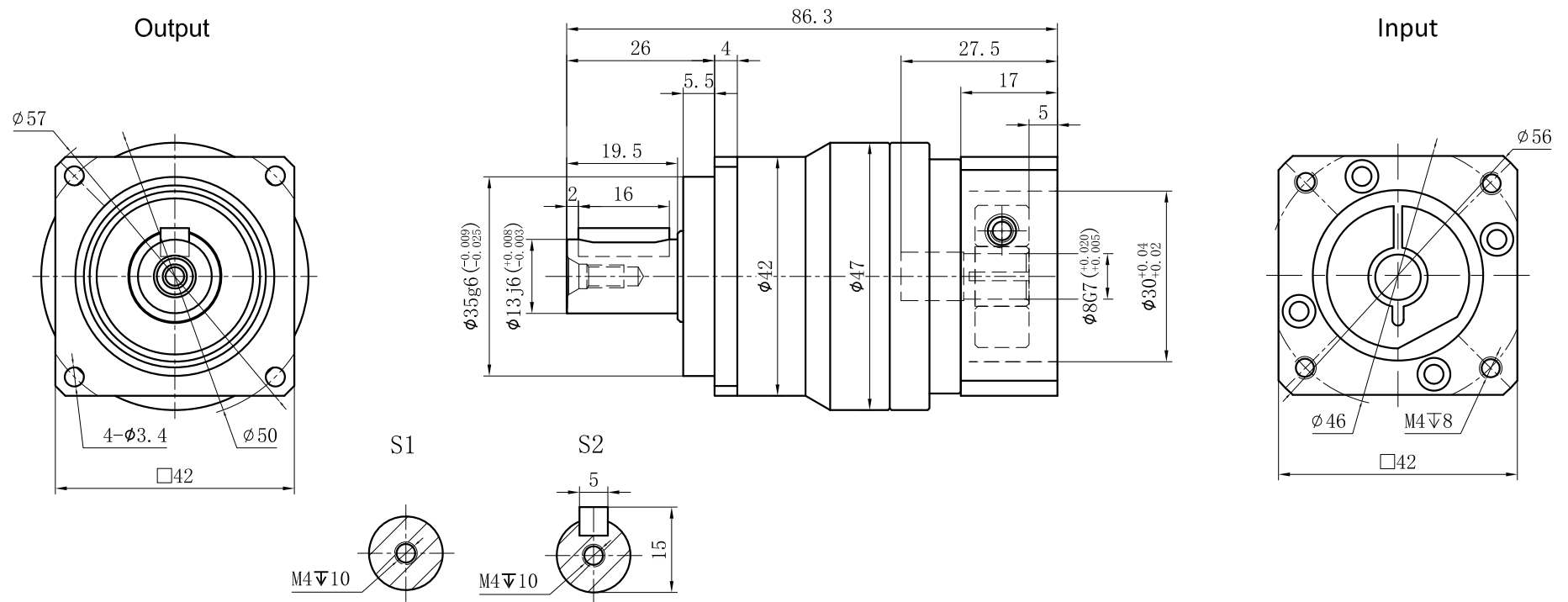

Transmission ratio	( A ):1	Mass moments of inertia	( B )Kg.cm <sup>2</sup>
Rated output torque	( C )Nm	Max.Output torque	( D )Nm
Rated input speed	3000rpm	Max input speed	6000rpm
Max.radial force	760N	Max.axial force	380N
Efficiency	≥ 97%	Operating temperature	-20°~+90°
Mounting position	Any	Lubrication method	Synthetic grease
Weight ±3%	--Kg	Service life	20000h
Standard backlash	≤ 5 arcmin	Protection class	IP65
Motor power		Noise level	56dB
Motor dimensions			

	10	0.03	14	25.2	Sign/Date					
	7	0.03	19	34.2						
	5	0.03	19	34.2						
	4	0.03	17	30.6						
Ratio	A	B	C	D		Ratio	A	B	C	D
NOTE						Precision Planetary Reducer	GCB042			
							GCB042-L1			
	Mark	No.	Sign	Date			Shaft Type	Precision		

Above specification are for standard reducer, No standard reducer only for reference